

16

Deck 502400

complete

1-yrx Deck

Rear Discharge 1040

Deck belt 502103 (BB89)

502236 - bare deck

Reflector Sub Assy 502312

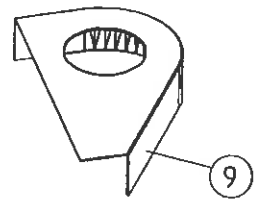
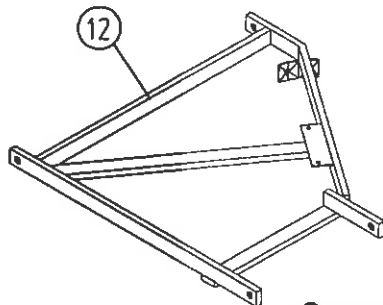
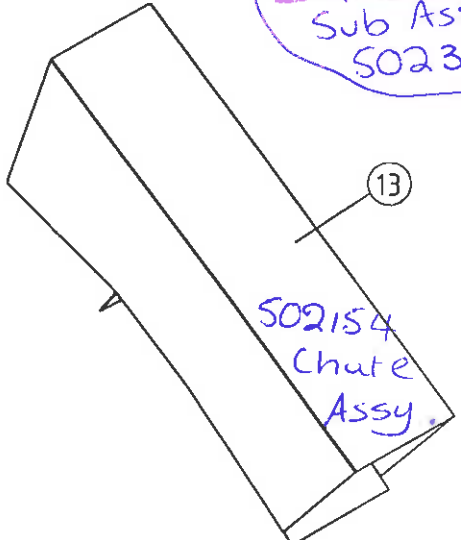

15 Nut for Spindle Assy.
16

6 850509 Pulley - 660

500111 Taper Bush Fits in Pulley

14 502109

(This is for the deck - not the tractor) Idler Pulley

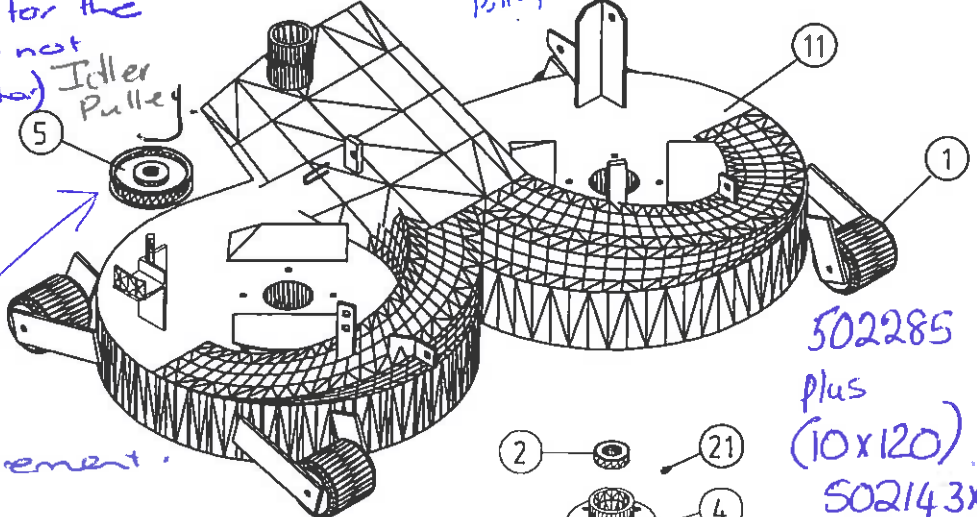
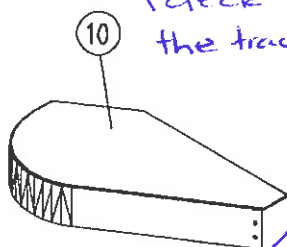

502285 plus (10x120) 502143x4 450127x4 750153x8

Check the measurement. More likely to be Clutch idler pulley

850117, Pressed Tin. outside dia 110 width 25 Brg 19.

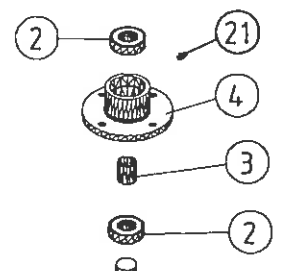
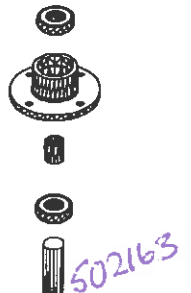
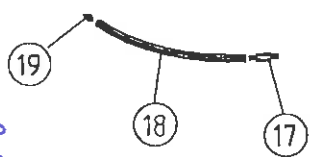

To lift deck.

Lift chain 502068 Link 750320 Pin (hanger 502241 deck front)

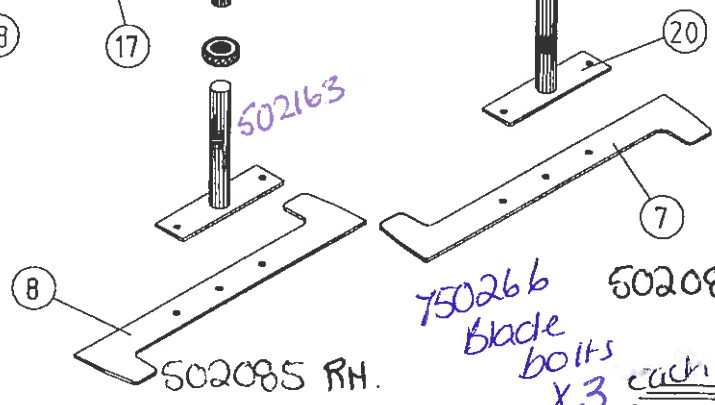

750266 blade bolts x3 each blade.

Deck Assy - RD1040



LYNX PARTS LIST - DECK ASSY - RD1040

1	502285	90mm Roller Sub Assy	4
2	750338	Bearing 6205 (2 per shaft)	4
	750282	Seal 35-52-7	4
3	758116	Spacer - Bearing	2
4	754148	Housing - Spindle	2
5	502286	Idler Pulley Sub Assy (bearing in it)	1
6	850509	Pulley - Spindle 660	2
7	502086	LH Blade - Lynx	1
8	502085	RH Blade - Lynx	1
9	502201	LH Belt Cover	1
10	502202	RH Belt Cover	1
11	502236	Cutter Deck	1
12	502112	Stabilizer	1
13	502154	Chute Assy	1
14	502109	Spacer - Spindle	2
15	758153	Nut - Nyloc M16 x 1.5 zp	2
16	500176	Washer - Spindle Pulley	2
17	750217	Connector - Male 68 x 1/4" x 1/8"	2
18	502186	Tube - Grease 145mm	1
19	502240	Nipple - Grease 1/8" x 45 BSP	1
20	502163	Spindle Assy	2
21	750219 502240	Nipple - Grease M6 x 1 Straight 1/8 BSP straight	1

PARTS NOT ILLUSTRATED

750324	Clip - Grip AG5 (2mm)	4
750320	Links - Lift Chain RC40-11	2
750383	Spring - Pan Return	2
500111	Bush - Taper	2
502091	Adjuster - Pan	2
500127	Lug Assy - Pan Lift	2
502241	Hanger - Deck Front (Pin)	2
502312	Deflector - Sub Assy	1

HARDWARE

502108	Washer - Loc 5/8" External ZP (Pan Adjuster)	4
750209	Nut - Hex M16 zp (Pan Adjuster Bolt)	4
750119	Screw - Set M8 x 30 M/S zp (Spindle Housing)	8
← 502066	751148 Screw - Csk A/Head M10 x 16 BL UNC (idl ply)	1
750266	Screw - Set M10 x 30 HT zp (Blade Bolts)	6
502125	Screw - Set M12 x 30 M/S zp (Con Arm Assy)	1
502072	Screw - Set M12 x 35 M/S zp (Con Arm Assy)	3
502143	Bolt - M10 x 120 M/S zp (Roller)	4
750160	Washer - Flat 1/4" x 5/8" zp (Belt Cover)	10
750145	Washer - Fender 1/4" x 1 1/4" zp (Chute Pivot)	2
750153	Washer - Flat M10 x 21 zp (Roller)	8
750101	Nut - Nyloc M6 zp (Belt Covers & Chute)	10
750102	Nut - Nyloc M8 zp (Spindle Housings)	10
750127	Nut - Nyloc M10 zp (Rollers & Blades)	8
750104	Nut - Nyloc M12 zp (Connecting Arm Assy)	4
750112	Screw - Set M6 x 16 zp (Belt Covers & Chute)	10
750303	Decal - Caution	2
751149	Washer - Csk (Idler Pulley)	1

Lynx Deck Belt Diagram
1040 mm deck

